

WS6VMH60W2AUS  
WS6VMH60X2AUS

Whirlpool

# INSTALLATION

Before operating your new appliance please read this instruction booklet carefully. It contains important information concerning the safe installation and operation of the appliance.

Please keep these operating instructions for future reference. Make sure that the instructions are kept with the appliance if it is sold, given away or moved.

The appliance must be installed by a qualified professional according to the instructions provided.

Any necessary adjustment or maintenance must be performed after the appliance has been disconnected from the electricity supply.

## Positioning and levelling

It is possible to install the appliance alongside cupboards whose height does not exceed that of the hob surface.

**This cooker should be installed directly on the floor. Do not install this cooker on an artificial base of any kind.**

Make sure that the wall in contact with the back of the appliance is made from a non-flammable, heat-resistant material (T 90°C).

**Important: Do not install this appliance adjacent to the door or other means of access to minimise the likelihood of persons using the door making contact with pans on the hob surface.**

To install the appliance correctly:

- Place it in the kitchen, dining room or the bed-sit (not in the bathroom).
- If the top of the hob is higher than the cupboards, the appliance must be installed at least 200 mm away from them.

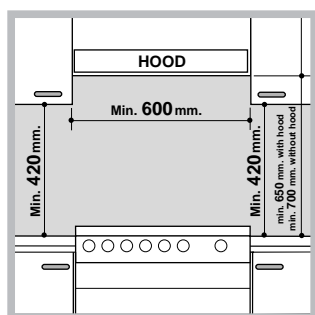

- If the cooker is installed underneath a wall cabinet, there must be a minimum distance of 420 mm between this cabinet and the top of the hob.

This distance should be increased to 700 mm if the wall cabinets are flammable (see figure).

- Do not position blinds behind the cooker or less than 200 mm away from its sides.
- Any hoods must be installed according to the instructions listed in the relevant operating manual.

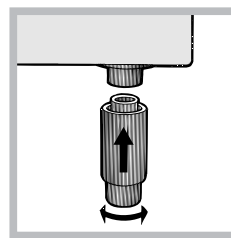

## Levelling

If it is necessary to level the appliance, screw the adjustable feet\* into the places provided on each corner of the base of the cooker (see figure).

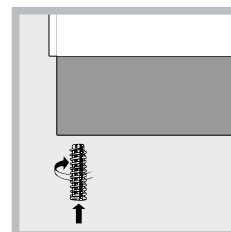

The legs\* provided with the appliance fit into the slots on the underside of the base of the cooker.

**The appliance must not be installed behind a decorative door in order to avoid overheating**

## Electrical connection

Ovens with a three-pole power supply cable are designed to operate with alternated current at the supply frequency and voltage indicated on the data plate (at the bottom of the oven dashboard). The earthing conductor of the cable is the yellow-green conductor.

Opening the terminal board:

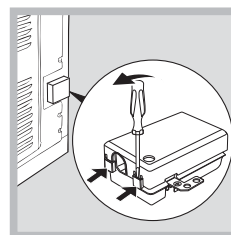

- Using a screwdriver, prise on the side tabs of the terminal board cover;
- Pull open the cover of the terminal board.

To install the cable, proceed as follows:

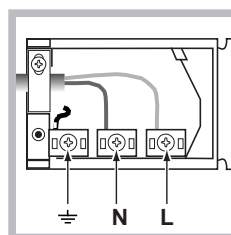

- Remove the wire clamp screw and the three contact screws L-N-⏏
- Fasten the wires beneath the heads of the screws using the following color scheme : **Blue (N) Brown (L) Yellow-Green ⏏**

- Fasten the supply cable in place with the clamp and close the cover of the terminal board.

## Connecting the supply cable to the mains

**WARNINGS: THIS APPLIANCE MUST BE EARTHED.**

The cooker must be connected to the mains by a switched (double pole) cooker outlet correctly fused with a capacity appropriate to that shown on the cooker Rating Plate. All electrical wiring from the consumer unit to the cooker, via the switched double pole cooker outlet, must be of an acceptable type and current rating as above.

the supply cable must be positioned so that it

never reaches at any point a temperature 50°C higher than the room temperature. The cable must be routed away from the rear vents.

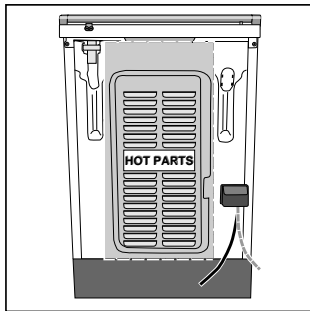

**The manufacturer declines any liability should these safety measures not be observed.**

We recommend cleaning the oven before using it for the first time, following the instructions provided in the "Care and maintenance" section.

**If the supply cord is damaged, it must be replaced by the manufacturer, its service agent or similarly qualified persons in order to avoid a hazard.**

### Safety Chain

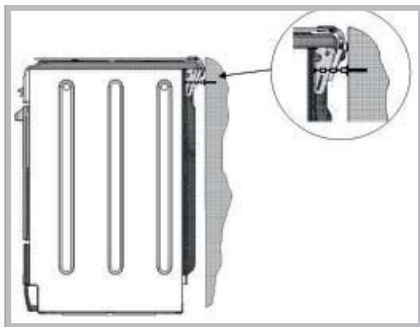

In order to prevent accidental tipping of the appliance, for example by a child climbing onto the oven door, the supplied safety chain **MUST** be installed!

The cooker is fitted with a safety chain to be fixed by means of a screw (not supplied with the cooker) to the wall behind the appliance, at the same height as the chain is attached to the appliance.

Choose the screw and the screw anchor according to the type of material of the wall behind the appliance. If the head of the screw has a diameter smaller than 9mm, a washer should be used. Concrete wall requires the screw of at least 8mm of diameter, and 60mm of length.

Ensure that the chain is fixed to the rear wall of the cooker and to the wall, as shown in figure, so that after installation it is tensioned and parallel to the ground level.

TABLE OF CHARACTERISTICS	
<b>Oven dimensions (HxWxD)</b>	32x43.5x40 cm
<b>Volume</b>	58 l
<b>Useful measurements relating to the oven compartment</b>	width 42 cm depth 44 cm height 8.5 cm
<b>Voltage and frequency</b>	see data plate Data plate, is located inside the flap or, after the oven compartment has been opened, on the left-hand wall inside the oven.
<b>Ceramic hob</b> Front Left Back Left Back Right Front Right Max. ceramic hob consumption	1700 W 1200 W 2100 W 1200 W 6200 W
<b>ENERGY LABEL</b>	Directive 2002/40/EC on the label of electric ovens. Standard EN 50304  Natural convection energy consumption heating mode: <input type="checkbox"/> Traditional mode  Declared forced convection energy consumption heating mode: <input checked="" type="checkbox"/> Multilevel.
	This appliance conforms to the following European Economic Community directives: 2006/95/EC dated 12/12/06 (Low Voltage) and subsequent amendments - 2004/108/EC dated 15/12/04 (Electromagnetic Compatibility) and subsequent amendments - 93/68/EEC dated 22/07/93 and subsequent amendments. 2002/96/EC 1275/2008 (Stand-by/Off mode)